



Paul Gooding

The White House, Main Street, Newton, NG13

Guide Price:

The White House, Main Street, Newton, NG13 8HN

An elegant and beautifully proportioned Georgian country house occupying a wonderful established plot of 2.68 acres. A portico period entrance with panelled doorway and arched fanlight opens into an impressive entrance hall with sweeping balustraded dogleg return staircase rising to first floor gallery landing. A beautifully appointed drawing room with open fireplace and French doors onto garden. Sitting room with period fireplace and fitted bookshelf and cupboards. Dining room with heavy exposed beams semi-open plan to stunning contemporary high specification kitchen diner with central island and large picture windows offering lovely views across the gardens. There is a downstairs WC and separate utility room. To the first floor is the principal bedroom with separate dressing room, three further bedrooms and two bathrooms. To the second floor are two further bedrooms. The property has a rear staircase and back door and would suit those looking to create secondary accommodation. The grounds and gardens are professionally landscaped to an exceptional standard to include sheltered stocked gardens, recreation areas, tennis court and paddock-ideal for equestrian users.

Accommodation & Amenities

- Elegant Georgian Country House of Distinction
- Beautiful Proportions & Stunning Period Features
- Flexible Accommodation with Two Staircases
- Three Characterful Receptions & Contemporary Kitchen Diner
- Principal Bedroom with Dressing Room, Five Further Bedrooms & Two Bathrooms
- Impressive Professionally Landscaped Grounds & Gardens
- 1.68 Acre Paddock that could suit Equestrian Users
- Beautifully Maintained Tennis Court

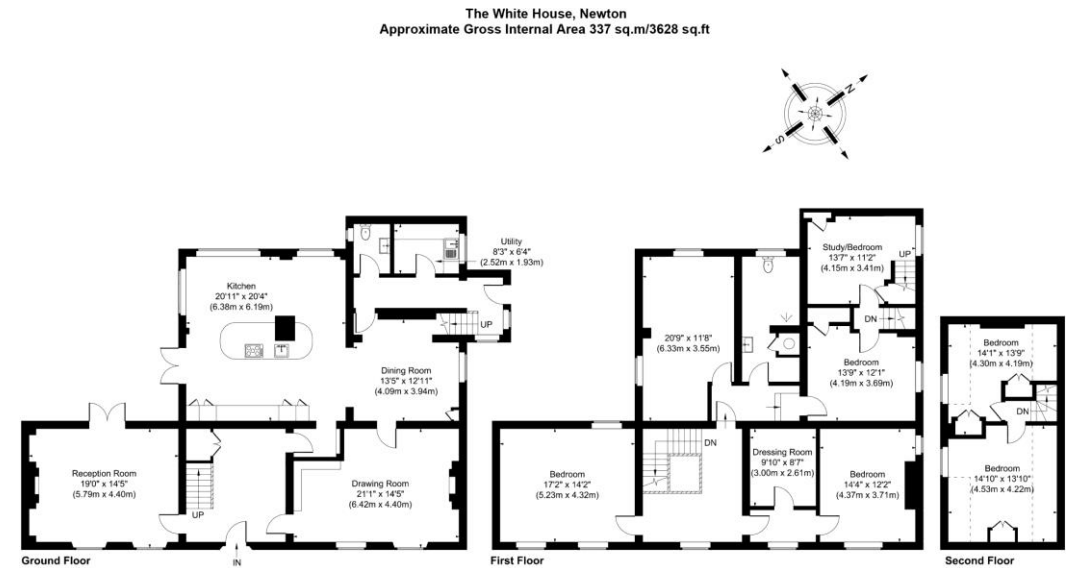

Illustration for identification purposes only, measurements are approximate, not to scale.
Newton Fallowell Estate Agents 01664 566210 © 2017















